

OGL LED SATURN 60 AC down lights



Installation Instruction

Applicable for Part Numbers:

LH110-W09-W, LH110-N09-W, LH110-C09-W

1. Product description – technical data

Product description	Part Number	LED Power	Colour Temp	Lumens output	Beam Angle	CRI	Dimmable	Mechanical Data
SATURN - OGL LED down light 10 Watt with integrated LED driver 240V AC 50Hz	LH110-W09-W	8.5 Watt	3,000K	850lm	60deg	>80	YES	Diameter: 110mm Height: 25mm White frame Cut-out: 90-95mm
	LH110-N09-W	8.5Watt	4,000K	900lm	60deg	>80	YES	
	LH110-C09-W	8.5 Watt	6,500K	950lm	60deg	>80	YES	

Part Number	Operating temp	IP rating	LED Efficacy	Compliance
CS110-W09-W	-10/+40deg C	IP40	100lm/W	CE, C-tick
CS110-N09-W	-10/+40deg C	IP40	106lm/W	CE, C-tick
CS110-C09-W	-10/+40deg C	IP40	118lm/W	CE, C-tick



Front view



Side/rear view

2. Dimming feature

OGL LED Saturn 60 AC dimmable down light is recommended to be used for best dimming performance with the following LED Dimmer: DIGINET

LEDsmart+™ Rotary Dimmer P/N: MMDM / RT available from electrical wholesaler shops.

3. Installation instruction

This series of OGL LED SATURN 60 AC down lights have to be installed according to Wiring Rules Standard AS/NZS 3000 : 2007 by Licensed Electrician.

The down light is equipped with Australian mains cable and 3-pin plug to be connected directly to 240V AC 50 Hz and must be connected to Earth.

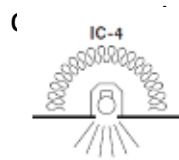

OGL LED SATURN down lights meet AS/NSZ 3000 : 2007 :

(i) (B) and AS/NZS 60598.2.2 and can be installed covered with glass wool insulation up to R6 rating (inclusive), providing that insulation meets AS1530.1 standard.

For details on installation please refer to the diagram below:

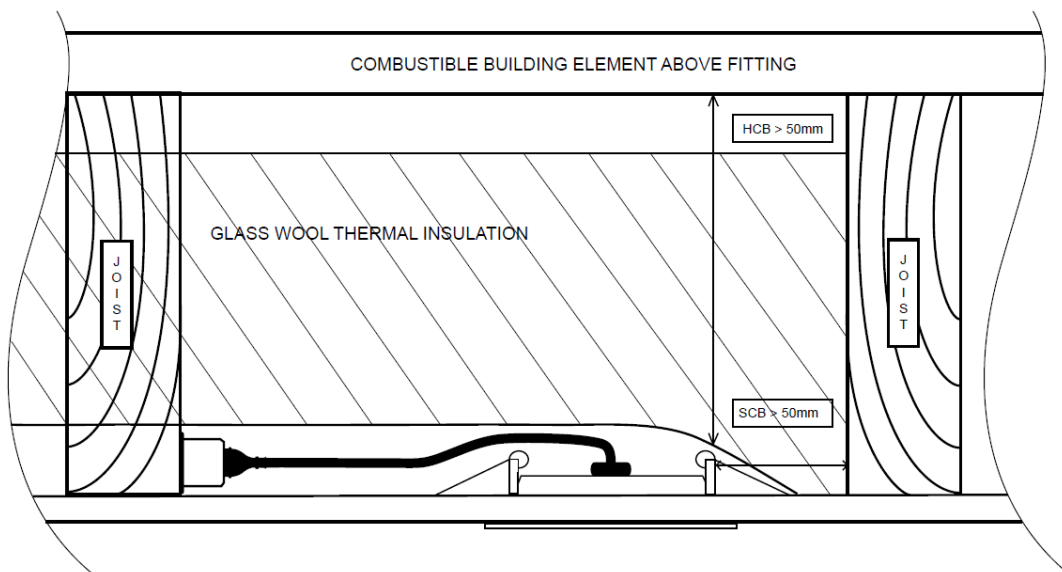

Abbreviation	Minimum clearances for OGL LED	Distance in mm
SCB	Side Clearance to building elements	50
HCB	Height Clearance to building elements	50

4. Disclaimers

4.1. This product must be installed and used as per these instructions.

4.2. This product to be installed internally only according to its IP rating.

4.3. This product is not suitable for installation in hazardous and/or corrosive areas.

4.4. This product contains no serviceable parts and no attempt should be made to repair this product.

4.5. This product has been designed to minimise the effect of transient voltage in electrical installation, but may not give full protection for extreme over-voltage transients such as those resulting from a close lightning strike.

4.6. The material in this product may vary in colour from batch to batch and colour matching from one batch to another can not be guarantee.

4.7. OGL reserves the rights to modify the specification of this product at any time.

5. Customer Service

For all Customer and Technical Support please send email to:

web@green-lighting.com.au

OGL Pty Ltd T/A Green Lighting

www.green-lighting.com.au